

NEVILLE & MORE

A TRICORBRAUN COMPANY®

PRODUCT CATALOGUE 2024



Bottles, Jars, Closures and Dispensers

For Standard and Bespoke Packaging
Across Multiple Industries

NEVILLE & MORE

A TRICORBRAUN COMPANY®

About Neville and More:

Neville and More is a leading packaging supplier with over 70 years of experience in supplying high quality primary packaging to multiple industries.

Our clients include global and local branded companies, pharmaceutical and generic manufacturers, laboratories, confectionary suppliers, food and beverage companies, entrepreneurial start-ups and retailers.

Our products include an extensive range of plastic bottles, PCR bottles, glass bottles, aluminium bottles, airless bottles, plastic jars, health supplement jars, glass jars, aluminium jars, lightweight glass bottles, bottles and vials for infusion and injectable products and dropper bottles.

We supply a large range of compatible plastic caps and dispensing systems including child-resistant caps, tamper-evident caps, flip top caps, disc top caps, plastic oral dosing syringes, finger sprayers, trigger sprayers, lotion dispensers, foamers, rubber stoppers in chlorobutyl and bromobutyl, dropper caps and pipettes and aluminium closures.

An enormous number of our products are available direct from stock with short lead times and flexible minimum order quantities.

The Neville and More difference



Neville and More is an ISO 9001:2015 Accredited Quality Management company.

Listening and understanding

- We genuinely listen to customer requirements and only move forward with projects when we fully comprehend our clients' needs.
- Our extensive knowledge of, and relationships with, top manufacturers and sourcing partners worldwide allow us to satisfy those requirements.
- This combination of understanding, knowledge and experience enables us to offer creative, reliable and cost-effective packaging tailored to customer needs.

We believe that our success is based on the simple objective of providing high quality, appealing, innovative packaging direct from stock, backed up by an enthusiasm and determination to provide exceptional customer service.



Speed and efficiency

- Neville and More stocks numerous innovative and appealing packaging items which means reduced lead times: we stock so you don't have to.
- We offer our customers an Exhibition and Sampling Centre they can visit to accelerate and simplify the packaging development process.
- We are experts in key manufacturing processes such as injection moulding, extrusion blow moulding, single and two stage injection stretch blow moulding and glass manufacturing.

Lowering your risk

- We provide supply chain management, including production scheduling and dual sourcing for just-in-time delivery and contingency arrangements for supply continuity.
- We have an in-house laboratory testing facility that offers accelerated product shelf life analysis and vacuum leak testing of container/closure compatibility.
- Our comprehensive supplier approval process includes vetting procedures such as supplier audits, risk assessment and supplier evaluation/validation.

Some examples of Neville and More's work with customers:

Worked with major UK healthcare brand owner to **re-source a spray dispenser** to overcome quality problems with incumbent supplier. **Validated product in Neville and More Testing Laboratory.**
Market volume SEVERAL MILLION UNITS

Invested in new capping and shrink wrapping facility to secure contract with major UK health and beauty retailer.

Annual volume SEVERAL MILLION UNITS

Managed the re-supply and stockholding facility of plastic bottles to support the relocation of the production of a healthcare brand from the USA to the UK.

Annual quantity 3 MILLION UNITS

Advised a pharmaceutical manufacturing facility on an alternative supply chain, **resulting in significantly reduced unit costs and shorter production and delivery lead-times** for a range of type 1 tubular glass vials and ampoules.

Annual volume SEVERAL MILLION UNITS

Created, launched and stocked a new range of sixteen standard plastic foamer bottles in PET and HDPE with **matching foamer heads** to support growth in popularity of foaming products.

Created an innovative, colour matched, cool matt frosted turquoise low profile jar for the initial launch of a hair sculpting crème. The initial production quantity of 10,000 units enabled the brand to launch an exquisite new pack whilst reducing the investment risk associated with an unproven product in a crowded marketplace.

Created a new range of bottles and matching brand embossed aluminium closures for a market leading brand of fishing baits. The transparent bottles enabled the vividly coloured product to achieve **maximum eye catching shelf impact and increased sales.**



Managed and completed plastic bottle material conversion for major healthcare brand owner. Created duplicate plastic bottle tooling in two different manufacturing facilities to provide dual sourcing and contingency planning.

Annual volume SEVERAL MILLION UNITS

Created flexible, cost effective, UK based manufacturing facility to produce large plastic supplement jars for UK healthcare company.

Consolidated the **supply of a range of glass and plastic jars and bottles**, including compatible closures, dispensers and sprayers for a major UK retailer. **The resultant partnership agreement** reduced component costs and delivery lead-times by **implementing a stockholding programme** at Neville and More's purpose built distribution centre.

Provided **reliable and cost-effective alternative** manufacturing source for UK retailer concerned about consolidation in the **supply base for plastic bottles and jars.**

Designed, launched and stocked a new range of nine different glass bottles and jars for cosmetic and beauty lotions, creams and fragrances. Range used by major UK fragrance retailer to rapidly launch new brand.

Developed **uniquely shaped plastic PET bottle and dispensing closure** for range of marinades and dressings for major UK supermarket.
Annual quantity over 500,000 UNITS.

Launched Tea brand in **innovative new plastic jar** following successful completion of **compatibility testing** with closure liner in **Neville and More Testing Laboratory.**



Featured products are available direct from our **extensive Stockholding Facility and Distribution Centre.**



It is essential to test all packaging to ensure compatibility with the filled product. Neville and More's In-House Laboratory Testing Facility (see page 28 for details) can carry out relevant testing on request.

Contents

Simplicity Bottles in Plastic (HDPE & PET) and Glass	6
Boston Round Bottles in PET and HDPE and PET Oval Bottles	7
Alpha Bottles in Plastic (HDPE and PET) and Lightweight Glass	8-9
Alpha Closures, Dosing Caps and Measuring Cups	10
Dropper Bottles in Glass and PET	11-12
Dropper Caps and Dropper Pipettes	13-14
Foaming Dispensers and Bottles	15
Airless Bottles and Vacuum Airless Jar Dispensers	16
Simplicity Jars in Plastic (PET and Polypropylene) and Glass	17
Omnijars in Plastic (HDPE and PET) and Glass	18
Large Omnijars in HDPE and PET	19
Round Dispenser, Square Gripper, Square and Simplicity Round Base and Label Recess PET Jars	20
Tamper-Evident PET Jars, Octagonal PET Jars, Round PET Jars with Multi-Start Twist-Off Neck and PET Clasp Jars	21
Thick Walled Jars	22-23
Clear PET Beverage Bottles with 38mm Tamper-Evident Neck and Added Value Products and Services	24-27
HPP Bottles and The Jottle	28
Neville Square PET Bottles, Miniature PET Bottles, Dry Powder & Glitter Spray Plastic Bottle Pumps and PET Oval Bottles	29
Multi-layer Plastic Bottles	30
Entice PET and Top Down PET Bottles	31
Food and Preserve Packaging	32
Glass Parenteral Vials and Bottles	33
Screw Neck Diagnostic Vials in Type 1 Glass in amber and clear glass	34
Dispensing Solutions for Healthcare and pharma products	34-41
Finger Sprayers with Overcap	37
Mini Trigger Sprayers	38
Treatment Pumps	39
Trigger Spray Dispensers, Tamper-Evident Lotion Dispensers, Powder Scoops and Poured Sprinkler Caps	40-41
Aluminium Bottles and Jars	42
Flexible Packaging	43
Design & Engineering from Concept to Shelf	44
Environmental Policy	45
Exhibition and Sampling Centre	46-47

Majority of bottles/jars available with PCR content, **please ask for more detail**

Simplicity Bottles in Plastic (HDPE and PET) and Glass

The Simplicity family is an extensive range in plastic (HDPE and PET) and glass cylindrical bottles.

Colours available direct from stock include clear PET, white and natural HDPE and clear glass.

All bottles in the Simplicity range have the same GCMI 410 neck specification, which enables absolute consistency for closure compatibility.

The versatile Simplicity bottle range is ideal for packaging liquids, gels and lotions which require a quality and secure environment.



HDPE Simplicity Bottles



PET Simplicity Bottles



Glass Simplicity Bottles

HDPE Simplicity Cylindrical Bottles

HDPE Simplicity cylindrical bottles sizes:

White:	30	50	60	100	125	150	200	250	300	400	500
Natural:	30	50	60	100	125	150	200	250	300	400	500

PET Simplicity Cylindrical Bottles

PET Simplicity cylindrical bottles sizes:

Clear:	10	20	30	50	60	75	100	150	200	250	300	400	500	1000
White:	-	-	-	-	-	-	-	-	-	-	-	-	-	1000

Glass Simplicity Cylindrical Bottles

Glass Simplicity cylindrical bottles sizes:

Clear:	30	50	100	150	200	250
--------	----	----	-----	-----	-----	-----



Trigger Spray Bottles in PET

Trigger Spray Bottles in PET sizes:

Clear:	500	750	1000
--------	-----	-----	------

Boston Round Bottles in PET and HDPE and PET Oval Bottles

The Boston Round family of bottles is an extensive range in PET and HDPE. Boston Round ranges have the same GCMI neck specification, which enables absolute consistency for closure compatibility.

The versatile Boston Round bottle range is ideal for packaging liquids, gels and lotions which require a quality and secure environment.

Majority of bottles/jars available with PCR content, **please ask for more detail**



PET Tall Boston Round bottles

PET Tall Boston Round Bottles

PET Tall Boston Round bottles sizes:

Clear:	50	75	100	125	150	200	250	300	400	500	750	1000
--------	----	----	-----	-----	-----	-----	-----	-----	-----	-----	-----	------



PET Boston Round bottles

PET Boston Round Bottles

PET Boston Round bottles sizes:

Clear:	40	50	75	100	150	250	300	400	500	750	1000
--------	----	----	----	-----	-----	-----	-----	-----	-----	-----	------



HDPE Boston Round bottles

HDPE Boston Round Bottles

HDPE Boston Round bottles sizes:

Natural:	100	150	250	300
White:	100	150	250	300



PET Oval Bottles

PET Oval Bottles

PET Oval bottles sizes:

Clear:	50	75	90	100
--------	----	----	----	-----

Alpha Bottles in Plastic (HDPE and PET) and Lightweight Glass

The Alpha family of bottles is an extensive range in plastic (HDPE and PET) and lightweight glass, available in sixteen different sizes from 15ml to 1000ml.

Colours available direct from stock include clear and amber PET, natural and white HDPE and clear and amber lightweight glass.

All bottles in the Alpha range have the same 28mm tamper-evident neck specification, which enables absolute consistency for closure compatibility.

The versatile Alpha bottle range is ideal for packaging liquids, gels and lotions which require a quality and secure environment.



HDPE Alpha cylindrical bottles

HDPE Alpha Cylindrical Bottles

HDPE Alpha cylindrical bottles available direct from stock include:

White:	60	125	250	500	1000
Natural:	60	125	250	500	1000



PET Alpha cylindrical bottles

PET Alpha Cylindrical Bottles

PET Alpha cylindrical bottles sizes:

Amber:	30	60	100	125	150	200	250	300	500	1000
Clear:	30	60	100	125	150	200	250	300	500	1000



Glass Alpha cylindrical bottles

Glass Alpha Cylindrical Bottles

Glass Alpha cylindrical bottles available direct from stock include:

Amber:	15	30	45	50	60	75	90	100	125	150	180	200	250	300	500	1000
Clear:	-	30	-	-	60	-	90	100	125	150	180	200	250	300	500	1000

PET Alpha Veral Cylindrical Bottles

PET Alpha Veral cylindrical bottles sizes:

Amber:	50	100	125	150	200	250	300	500	1000
Clear:	50	100	-	150	200	250	300	500	1000
White:	50	-	-	-	-	250	-	500	1000



PET Alpha Veral cylindrical bottles

Alpha Bottles Dressed And Ready For Action



A variety of closures and styles available with PCR content, **please ask for more detail**

Alpha Bottle Closures

A stunning range of standard Alpha Closures is available direct from stock. Includes plastic closures, aluminium caps, child-resistant caps, tamper-evident caps, finger sprayers, lotion dispensers, flip top caps and dropper pipettes.



A variety of closures and styles available in all plastic, **please ask for more detail**

*Sweeten the
aroma of any
room with an...*



Alpha Reed Diffuser bottle

30ml to 1000ml
sizes available

All capacities in ml.

Alpha Closures, Dosing Caps and Measuring Cups



Alpha Tamper-Evident Closures

A range of tamper-evident closures available direct from stock, with liner or plug seal. Special colours available for minimum order of 30,000 units.



Alpha Child-Resistant and Tamper-Evident Closures

A range of child-resistant and tamper-evident closures available direct from stock. Special colours available for minimum of 30,000 units.



Alpha Dropper and Dosing Closures

A range of dosing and dropper caps with the added benefits of child-resistance and tamper-evidence.



Alpha Measuring Cups

An extensive range of CE marked measuring cups, designed to fit on the Alpha child-resistant and tamper-evident closure ranges.



Alpha Plastic Oral Dosing Syringes

A comprehensive range of CE marked, graduated plastic oral dosing syringes in a variety of sizes including 0.5ml, 1ml, 3ml, 5ml, 10ml and 20ml. Press-in-bottle adaptors available for both glass and plastic bottles to enhance convenience. Individual protective sachet option available to enhance cleanliness.



Tamper-Evident Lotion Dispensers

Tamper-evident Lotion Dispensers are designed to enhance product safety and integrity. The tamper-evident band on the closure of the dispenser provides a deterrent to opening or interfering with the contents of the bottle.

Metal-free fluid path enhances protection for sensitive product formulations.

Dropper Bottles in Glass and PET

A range of glass and plastic dropper bottles. Glass bottles available direct from stock include amber, clear, blue and green. Plastic bottles available direct from stock include amber and clear PET. Sizes range from 5ml to 100ml.



Glass Dropper Bottles

Glass Dropper Bottles

Glass Dropper Bottles available direct from stock include:

Amber:	10ml	20ml	30ml	50ml	100ml
Clear:	5ml	10ml	30ml	-	-
Blue:*	5ml	10ml	30ml	-	-

* Please consult us for current availability on blue and green glass dropper bottles



PET Dropper Bottles

PET Dropper Bottles

PET Dropper Bottles sizes:

Amber:	10ml	20ml	30ml	50ml
Clear:	10ml	20ml	30ml	50ml



Glass Roller Ball Bottles

Available with different material balls and a PP screw cap (Ball materials available in PP/Glass/Stainless Steel)

Amber:	5ml	10ml	30ml
Clear:	5ml	10ml	30ml
Blue:	5ml	10ml	30ml

All capacities in ml.

Dropper Pipettes

A range of 18mm DIN Pipette dropper caps with plastic or rubber teats and glass or plastic pipettes. Child-Resistant and Tamper-Evident options available



Teat Dropper Pipettes with metal overshell



Tamper-Evident Pipettes

Lotion and spray pumps specifically developed for use with dropper bottles



Dropper Caps

Available direct from stock in black and white

With CUSTOM COLOURS available on request

With over 70 different dropper and dosing inserts in stock we can meet specific dispensing performance requirements for a huge variety of dropper speeds, flow properties and liquid viscosities.

All our dropper and dosing inserts come pre-assembled into a simple screw on cap, a tamper-evident cap, a child-resistant cap or a combination child-resistant and tamper-evident cap. This pre-assembly means it is very easy to apply the dropper and cap to the bottle in a single action.

There are two main types of dropper inserts: Horizontal Droppers and Vertical Droppers.

Horizontal Droppers

Horizontal droppers are also commonly known as rim droppers or all round droppers.

This type of dropper can be used for an extremely wide spectrum of applications and is generally specified when precise dosing of product is not an absolute requirement due to the fact that the dosing volume of this type of dropper may vary. This variance results from the angle (normally between 120 - 150 degrees) at which the bottle is held by individual consumers when dispensing the product. The Horizontal Dropper has a central air hole surrounded by a series of smaller liquid dispensing holes positioned in a circle.

Horizontal Dropper

Holding position for dispensing.

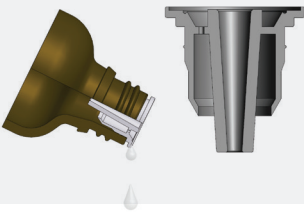

Vertical Droppers

Vertical Droppers, as the name suggests, are used for dispensing liquids when the bottle is held at 180 degrees (upside down). Vertical droppers are designed to dispense very precise drop volumes with low variation in dosage.

The Vertical Dropper is designed with two channels: a central dropper channel from where the liquid exits the bottle and a longer side air channel to allow the air back into the bottle. The dropping speed, drop size and weight are controlled by the diameter of the apertures in the liquid and air channels. We stock a wide range of vertical droppers with varying aperture sizes to enable specific dispensing performance tailored to the precise characteristics of the liquid.

Vertical Dropper

Holding position for dispensing.

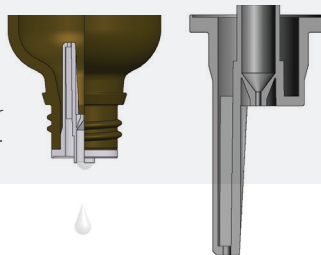

Dropper caps



Tamper-evident dropper caps



Child-resistant, tamper-evident dropper caps: ribbed style



Child-resistant dropper caps: smooth style



We have a large range of alternative dropper inserts available to provide different dropping speeds and performance suited to products of different viscosity.

Please contact us for advice on the best dropper to suit the dispensing requirements of your product.

All capacities in ml.

Dropper Pipettes



We offer a wide range of dropper pipette solutions for healthcare and pharma applications. Standard dropper bulb materials include natural rubber, butyl rubber and TP (injection moulded thermoplastic elastomere, which are available in a range of different colours). Standard pipette materials include glass and polypropylene plastic which can be tailored to the exact height of the dropper bottle. Pipettes can also be supplied with printed graduations.

Clean Sachet Packaging

Pipettes can be supplied in protective sachets for enhanced cleanliness. Clean room assembly an additional option. Please consult us for further information.



Our pipette closures are available as non tamper-evident or tamper-evident for enhanced product protection.

Sterilisation and CE Mark Development

Pipettes can be supplied sterile in sealed plastic sachets using a variety of sterilisation options including gamma irradiation, ethylene oxide or steam sterilisation. Sachet labelling includes full batch traceability and expiry date. We also offer a comprehensive medical device CE Mark development process with CE Mark authorized body identification clearly marked on each individual pipette protective sachet.

Foaming Dispensers and Bottles

Foaming Dispensers create a **smooth, rich foam to enhance the consumer experience. Instant foaming provides an invigorating and luxurious user experience.**



Neville and More stocks a range of Hand Held Foamer dispensing heads and Mini Foamer dispensing heads, together with an extensive range of compatible bottles in PET and HDPE.



Hand Held Foamers 43mm neck

A range of four different bottles; 100ml, 150ml, 200ml and 250ml in both HDPE and PET.



Mini Foamers 30mm neck

A range of four different bottles; 30ml, 50ml, 80ml and 100ml in both HDPE and PET.



24mm 410 Foamer

A foaming dispenser specifically developed for use on standard bottles with a common 24mm 410 neck, which converts existing standard bottles into foamer bottles.

Airless Bottles and Vacuum Airless Jar Dispensers



Airless Bottles

An extensive range of Airless Containers offering significant advantages including:

- Protection of product from oxygen degradation/contamination so increased shelf life and maintenance of product integrity
- Protection against microorganisms
- Enables usage of all the product in the container...leading to reduced wastage
- Reduction in the usage of synthetic anti-microbial preservatives in products
- The pack can be used in an upside down position for versatile application
- Can be used to dispense high viscosity products
- Extended product shelf life
- Composed of only 7 component parts so easier to recycle

Standard Airless Bottle sizes include:

15 30 50 100 150 200

Twin Stack Airless Bottles



An ideal pack format for two cream, lotion or gel product applications that are used together or in succession. Available in 10ml and 15ml formats.

Vacuum Airless Jar Dispensers

- Suitable for dispensing heavy, viscous products
- Easily adjustable output 3ml/5ml/7.5ml
- Double tamper-evidence on the dispenser and the container
- Lockable pump to prevent unintentional dispensing
- Self-closing protective nozzle to prevent drying or contamination of the contents
- Available in single carton quantities from stock

Sizes available include:

250 350 500 600 750 1000 1500 1750



All capacities in ml.

Majority of bottles/jars available with PCR content, **please ask for more detail**

Simplicity Jars in Plastic (PET and Polypropylene) and Glass

The Simplicity range is an extensive range of jars in plastic (PET and polypropylene) and glass, available in more than thirty different sizes from 10ml to 5,000ml.

Colours available direct from stock include clear PET, natural and white polypropylene, clear and amber glass. All jars in the Simplicity range have the same GCMI 400 neck specification, which enables absolute consistency for closure compatibility.

The versatile Simplicity jar range is ideal for packaging a wide range of products including supplements, capsules, powders, creams, gels, pastes, ointments, exfoliators, scrubs, body butters, masks, hand, foot and haircare and bath salts.



PET Simplicity Jars



Polypropylene Simplicity Jars



Glass Simplicity Jars: clear



Glass Simplicity Jars: amber

PET Simplicity Jars

PET Simplicity jars sizes:

Clear:	25	50	75	100	150	200	250	300	350	370	400	-
	500	730	750	1000	1250	1400	1500	2000	2200	2500	3000	5000

Polypropylene Simplicity Regular Wall and Thick Wall Jars

Polypropylene Regular Wall and Thick Wall jars available direct from stock include:

Regular Wall White:	10	20	30	60	75	100	125	175				
	200	250	350	400	500	600	750	1250				
Regular Wall Natural:	10	20	30	60	75	100	125	175				
	200	250	350	400	500	600	750	1250				
Thick Wall White:	5	10	20	30	60	75	125	175	200	250	350	400
Thick Wall Natural:	5	10	20	30	60	75	125	175	200	250	350	400

Glass Simplicity Jars

Simplicity jars available direct from stock include:

Clear:	15	30	60	120
Amber:	15	30	60	120

Simplicity Jar Closures

An extensive range of high quality closures available direct from stock includes polypropylene screw on caps in matt, ribbed or smooth surface finish and aluminium closures. Simplicity jar closures are available with a wide choice of liner material options including tamper-evident induction seal liners for enhanced product protection.



PP closures available with PCR content, **please ask for more detail**

Omnijars in Plastic (HDPE and PET) and Glass

The Omnijar family of jars is an extensive range in plastic (HDPE and PET) and glass, available in fifteen different sizes from 40ml to 1200ml.

PET sizes are also available in cobalt blue, black, emerald green and white.

The versatile Omnijar range is ideal for packaging a wide range of products including supplements, capsules, powders, creams, gels, pastes, ointments, bath salts and crystals.



PET Omnijars

PET Omnijars

PET Omnijars sizes:

Clear:	75	100	120	150	200	250	300	400	500	625	750	950
Amber:	75	100	120	150	200	250	300	400	500	625	750	950



HDPE Omnijars

HDPE Omnijars

HDPE Omnijars sizes:

White:	40	60	75	100	120	150	200	250	300	400	500	625	750	1200
--------	----	----	----	-----	-----	-----	-----	-----	-----	-----	-----	-----	-----	------

Glass Omnijars

Glass Omnijars sizes:

Amber:	60	100	120	150	175	200	250	300	400	500	625
--------	----	-----	-----	-----	-----	-----	-----	-----	-----	-----	-----



Omnijar Closures

An extensive range of high quality closures including polypropylene screw on caps in matt or smooth surface finish, Hingeguard snap on tamper-evident closures with tear off tamper-evident band for PET Omnijars, Flip open dispenser caps, aluminium closures and child-resistant caps. Omnijar closures are available with a choice of more than eighty different liner material options including tamper-evident induction seal liners for enhanced product protection.



Glass Omnijars

Tamper-Evident Polypropylene Jars

Tamper-evident Polypropylene Jars sizes:

White:	15	20	30	50	75	100	125	150	250	350
	500	600	750	1000	1500	1750				



Tamper-evident Polypropylene jars

All capacities in ml.

Large Omnijars in HDPE and PET

Ideal for packaging a wide range of products. Standard closures include aluminium, and black and white polypropylene with a range of liners including induction seal for tamper-evidence.



Large HDPE Omnijars

Large HDPE Omnijars

Large HDPE Omnijars include:

Black:	1.5 litre	3 litre	6 litre	10 litre
White:	1.5 litre	3 litre	6 litre	10 litre



Large PET Omnijars

Large PET Omnijars

Large PET Omnijars include:

Straight sided jar style:	1500	2000	2500	3000	5000
Recessed label area jar style:	1250	2250	2500	3000	

Large Omnijar Closures

An extensive range of high quality closures available direct from stock including polypropylene screw on caps in matt, ribbed or smooth surface finish and aluminium closures. Large Omnijar Closures are available with a wide choice of different liner material options including tamper-evident induction seal liners for enhanced product protection.



Wide Neck Child-Resistant Polypropylene Jars

A range of wide neck polypropylene jars with flush fitting 53mm, 63mm and 70mm Child-resistant Closures.



50ml (53mm neck) 100ml (63mm neck) 100ml square (63mm neck) 200ml (70mm neck)

All capacities in ml.

Round Dispenser, Square Gripper, Square and Simplicity Round Base and Label Recess PET Jars



Round Dispenser PET Jars

Round Dispenser PET Jars

A range of cylindrical PET jars with deep 63mm continuous screw neck.

Round Dispenser PET Jars include:

Clear:	60	100	175	230	330	500	1000
--------	----	-----	-----	-----	-----	-----	------



Square Gripper PET Jars

Square Gripper PET Jars

A range of square shaped PET jars with a user friendly integral gripper handle for ease of use.

Square Gripper PET Jars include:

Clear:	300	500	700	1000
--------	-----	-----	-----	------



Square PET Jars

Square PET Jars

A range of square shaped PET jars with standard necks.

Square PET Jars include:

Clear:	250	375	475	500	1000
--------	-----	-----	-----	-----	------



Simplicity Round Base and Label Recess PET Jars

Simplicity Round Base and Label Recess PET Jars

A range of cylindrical PET jars with either a rounded base and/or an indented label recess area.

Simplicity Round Base and Label Recess PET Jars include:

Clear:	100	200	250	300	370	500	730	750	1000
	1250	1500	2000	2250	2500	3000	4000	5000	

Tamper-Evident PET Jars, Octagonal PET Jars, Round PET Jars with Multi-Start Twist-Off Neck and PET Clasp Jars



Tamper-evident PET Jars

Tamper-Evident PET Jars

A range of cylindrical PET jars with deep 82mm continuous screw neck.

Tamper-evident PET Jars include:

Clear:	500	600	700	1000
White:	500	600	700	1000



Octagonal PET Jars

Octagonal PET Jars

A range of octagonal shaped PET jars with standard twist-off necks.

Octagonal PET Jars include:

Clear:	100	375	400	500	710
	1000	2000	2500	3250	5000



Round PET Jars with Multi-Start Twist-off neck

Round PET Jars with Multi-Start Twist-Off neck

A range of cylindrical PET Jars with standard twist-off neck.

Round PET Jars include:

Clear:	200	250	300	400	450	500	700
	750	1000	1500	1800	2000	2250	



PET Clasp Jars

PET Clasp Jars

A range of high quality Clasp Jars in unbreakable PET.

PET Clasp Jars include:

Clear:	50	150	200	350	500
--------	----	-----	-----	-----	-----

Thick Walled Jars

These versatile, high quality, thick walled jar ranges are ideal for packaging a wide range of products including high end skincare brands, lip balms, gels, creams, lotions and scrubs.



Thick wall glass jars

Thick Wall Glass Jars

Glass Thick Wall jars sizes:

Clear:	7	15	30	50	60	120
Amber:	-	-	30	-	60	120



Thick wall PETG jars

Thick Wall PETG Jars

PETG Thick Wall jars sizes:

Clear:	3	5	7	15	30	50	
Clear: low profile				50	75	150	200



Veral glass jars

Veral Glass Jars

Glass Veral jars sizes:

Clear:	15	30	50	100
Amber:	15	30	50	-
Blue:	15	30	50	-
Green:	15	30	50	-
Black:	15	30	50	100

Add a glint of metal by selecting a stunning shiny or matt aluminium overshell cap.



All capacities in ml.

Add a touch of class by specifying a coloured matt effect plastic closure.



Low Profile Wide Neck Polypropylene Jars

Available in either a sumptuous matt or zingy gloss finish, with compatible stacking lid closures.



Low profile wide neck polypropylene jars

Low profile wide neck polypropylene jars sizes:

5	10	50	75	100	200	300
---	----	----	----	-----	-----	-----

Round Dispenser PET Jars

A range of cylindrical PET jars with deep 63mm screw necks.

Round Dispenser PET jars sizes:

Clear: 100	230	330	500	1000
------------	-----	-----	-----	------



Round dispenser jars

Tapered Polypropylene and PET Jars

A range of tapered polypropylene and PET jars.

Tapered jars sizes:

Polypropylene	50	100	200	300
PET	100	150	200	-



Tapered Jars

All capacities in ml.

Clear PET Beverage Bottles with 38mm Tamper-Evident Neck

Square

A range of square shaped PET bottles with 38mm tamper-evident caps

Clear: 50 (28mm neck) 80 125 250 330 400 500 1000



Square PET Bottles



NevBev PET Bottles

NevBev

A range of round PET bottles with 38mm tamper-evident caps

Clear: 100 125 250 330 500 750 1000



Omni PET Bottles

Omnibottle

A range of round PET bottles with 38mm tamper-evident caps

Clear: 250 330 500 750 1000 2000

All capacities in ml.



Clear PET Beverage Bottles with 38mm Tamper-Evident Neck

Simplicity

A range of round PET bottles with 38mm tamper-evident caps

Clear:	150	200	250	500	1000
--------	-----	-----	-----	-----	------

Simplicity PET Bottles



Alpha PET Bottle 38mm neck

A range of round PET bottles with 38mm tamper-evident caps

Clear:	60	120	250	500
--------	----	-----	-----	-----

Alpha PET Bottles

38mm Tamper-Evident Closures

An extensive range of coloured 38mm tamper-evident closures available direct from stock and compatible with the full range of bottles.



PET Beverage Bottles Added Value Products and Services

Packaging Options



Our beverage bottles are available in a range of different packaging options including palletisation on large trays or capped and tumble packed into individual cardboard boxes.

A range of dispenser pumps ranging in size from 2ml through to 15ml.

Ideal for dispensing sauces, syrups, mayonnaise and ketchups.



Coloured Caps

We now stock a wide range of tamper-evident 38mm caps with an extensive choice of colours.



HPP Bottles

A range of plastic (PET) bottles specifically for use during High Pressure Processing (HPP) treatment of Food and Beverage products. For further information, refer to page 17.



Innovative brand logo embossing for enhanced brand differentiation and identity.

We are now able to offer cost effective brand logo embossing capabilities for PET Beverage Bottles.

Bottle sizes available for this innovative new service range between 250ml and 2000ml.

PET Beverage Bottles Added Value Products and Services

PET Recyled from PCR (Post Consumer Resin)

We offer a range of bottles
manufactured using up to
100% recycled plastic resin.



CAP IT OFF

New Elegant Aluminium Twist Off Beverage Closure

A brand new 38mm non tamper-
evident aluminium closure, designed to
fit our range of PET Beverage Bottles.



Shot bottles

A range of PET SINGLE SHOT
round or square beverage bottles in
sizes ranging from 60ml to 125ml.



Labelled bottles

We can deliver your bottles pre-labelled,
ready to fill, with a pre-capped option.
Simply send us your label artwork and we
will do the rest.

Have a shot of...



HPP Bottles and The Jottle

HPP (High Pressure Processing) Bottles



HPP Bottles

A new range of plastic (PET) bottles, specifically for use during High Pressure Processing (HPP) treatment of beverage products.

This extensive range of bottles includes 40 different products, ranging in size from 30ml to 1000ml capacity. Shapes include round and square.

Single shot sizes are available in 30ml, 50ml, 60ml, 100ml and 125ml capacities.

The entire bottle range is compatible with tamper-evident closures to enhance product safety.

The tamper-evident closures have been designed to retain the integrity of the bottle closure seal during the high pressure treatment, ensuring that no leakage of product occurs during or after the treatment process.

This specification means the bottles are ideal for retaining the fresh flavour of products such as juices and smoothies.

The non-thermal HPP process keeps the original fruit/vegetable taste and colour, allowing the creation of high quality premium beverage products.

The desired microbial inactivation is achieved whilst ensuring the nutritional and functional properties of the products remain intact. This process is therefore beneficial for use in the development of natural, organic, preservative free and functional products, whilst at the same time extending product shelf-life.

In addition to the standard HPP bottle range, Neville and More can also design and create a specific custom developed bottle shape with brand name embossing.



The Jottle

The Jottle

The Jottle is a jar in the shape of a bottle or a bottle in the shape of a jar ... whichever description you prefer. The Jottle is available in a 500ml size, with the Champagne Jottle available in the larger 1100ml and 1700ml sizes. The Jottles have a detachable closure at the base for filling and accessing the product.

The Jottle and associated closures are stock items at Neville and More with a minimum order of just a single pallet.



Neville Square PET Bottles, Miniature PET Bottles, Dry Powder & Glitter Spray Plastic Bottle Pumps and PET Oval Bottles



Neville Square PET Bottles

The Neville Square family of bottles is a range of imposing square bottles in clear PET. All Neville Square PET bottles have the same tamper-evident neck specification, which enables absolute consistency for closure compatibility.

The versatile Neville Square bottle range is ideal for packaging liquids, sauces, marinades, oils, vinegars and dressings which require a quality and secure environment.

Neville Square PET bottles include:

Clear:	150	250
--------	-----	-----



Miniature PET Bottles

An extensive range of miniature PET bottles from 10ml to 50ml in cylindrical and square shapes. Perfect for packaging small or sample packs of a wide range of liquid products.



Dry Powder and Glitter Spray Plastic Bottle Pumps

A range of spray pumps ideal for dispensing solid dose products such as cake decoration products.

Available in 14ml, 18ml, 25ml, 30ml, 35ml, 50ml, 60ml, 80ml, 110ml, 120ml, 140ml and 180ml capacity.

All capacities in ml.

Multi-layer Plastic Bottles

Multi-layer plastic bottles are produced by a process known as co-extrusion. This results in the production of plastic bottles with walls that are composed of layers of different materials bonded together (in this case, polypropylene and EVOH).

The multi-layer provides a barrier to oxygen ingress which means **enhanced product shelf life**. This is particularly beneficial for food products.

The multi-layer structure of the bottle walls also enables them to be **hot filled at an elevated temperature** of around 96 degrees Celsius to prevent bacterial growth.

Multi-layer bottles are ideal for packaging a wide range of products including liquids, sauces, pastes, pickles, marinades, oils, dressings and condiments, all of which require a quality and secure environment.



Multi-layer Plastic Bottles

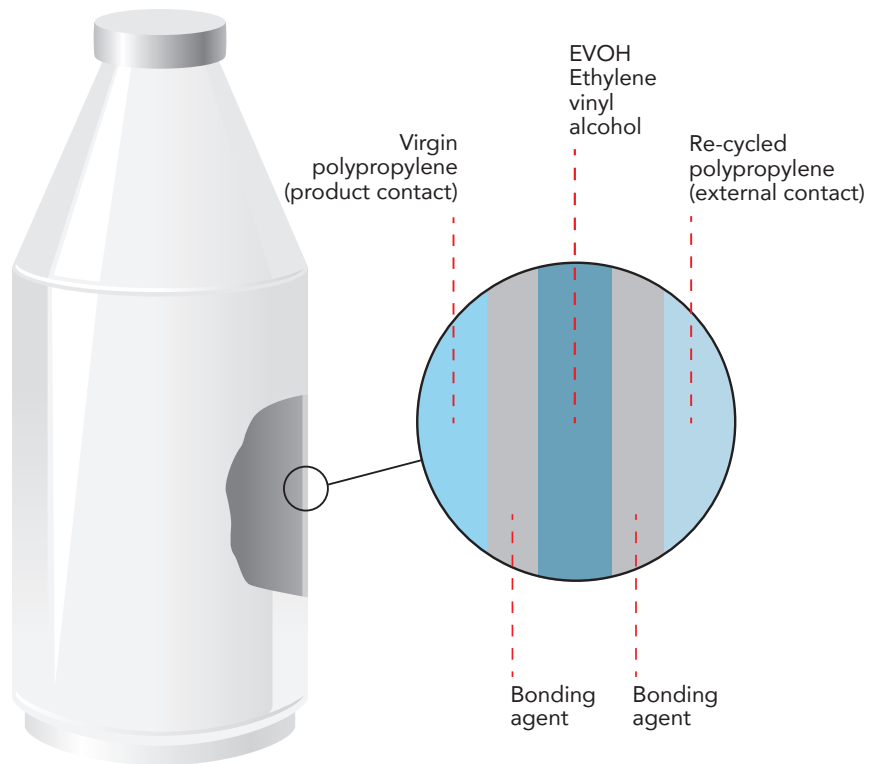

Multi-layer PP-EVOH-PP bottles:

Top Down oval: 290 321 460 515 740 970

Entice PET and Top Down PET Bottles

Entice PET Bottles

A range of squeezable PET Oval bottles in four sizes from 180ml to 425ml.

The versatile Entice bottle range is ideal for packaging liquids, sauces, marinades, oils, dressings and honey. Entice bottles can be stored either Top Up or Top Down where the product is ready for immediate pouring/dispensing.



Screw neck Entice PET Bottles

Screw neck Entice PET Bottles

Entice PET Bottles sizes:

Clear: 180 250 350 425



Top Down PET Oval Bottles

Top Down PET Oval Bottles

A range of squeezable PET Oval Bottles

Clear: 300 452 520 560 920



Large Aperture

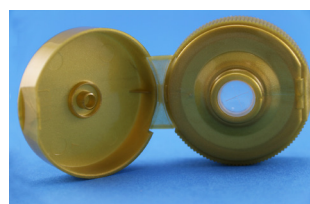

Squeazy Valve Opening

Closure options

Compatible closures include 38mm flip top cap and 38mm flip top cap with valve seal for controlled squeeze dispensing. The closures are available with a wide choice of liners including induction heat seal for tamper-evidence.



Food and Preserve Packaging

A Range Of Beautiful And Versatile Glass Jars

Ideal for preserves, pickles, herbs, salts, ready to eat foods and so much more! Variety of closures available to finish off your project. Direct from stock in our UK warehouse (subject to requirements)

Sizes range from 65ml to 310ml (other sizes available on request).

Plastic Packaging

We have a range of injection moulded, tamper proof, food grade plastic packaging – primarily for the food industry. Our packaging satisfies all legal requirements for hygiene, while remaining environmentally friendly: PP plastic (polypropylene) is 100% recyclable. Product shapes include round, rectangular and square.

Sizes range from 180ml to 1200ml (other sizes available on request).



Glass Parenteral Vials and Bottles

Injection Vials in Moulded Type 1, Type 2 and Type 3 Glass



Injection Vials in Tubular Type 1 Glass

A range of Injection and Freeze Dry Neutral Type 1 Glass Vials in amber and clear glass with 13mm and 20mm crimp necks. Custom vials also available to suit customer requirements.

Manufactured to ISO 8362 specifications.

Sizes available include:

2 4 5 6 8 10 15 20 25 30 50 100

Glass Infusion Bottles

A range of clear glass crimp and screw neck infusion bottles

Glass Infusion bottles sizes:

Clear 32mm	50ml type 1	50ml type 2	
Crimp Neck:	100ml type 1	100ml type 2	100ml type 3
	250ml type 1	250ml type 2	
	500ml type 1	500ml type 2	
	1000ml type 1	1000ml type 2	
Clear Screw Neck:	100ml type 1		
	125ml type 1		
	300ml type 1		
	500ml type 1		
	1000ml type 1		

All capacities in ml.

Glass Injection Vials

Glass Injection vials sizes:

Amber:	5ml type 1		
	10ml type 1	10ml type 2	10ml type 3
			15ml type 3
	20ml type 1	20ml type 2	20ml type 3
	30ml type 1	30ml type 2	30ml type 3
	50ml type 1	50ml type 2	50ml type 3
	100ml type 1	100ml type 2	100ml type 3
Clear:	5ml type 1		
	10ml type 1	10ml type 2	10ml type 3
			15ml type 3
	20ml type 1	20ml type 2	20ml type 3
	30ml type 1	30ml type 2	30ml type 3
	50ml type 1	50ml type 2	50ml type 3
	100ml type 1	100ml type 2	100ml type 3
	200ml type 1		

Ready to use sterilised options available



Screw Neck Diagnostic Vials in Type 1 Glass in amber and clear glass



Aluminium Crimp Seals

An extensive range of 13mm, 20mm and 32mm aluminium crimp seals for parenteral bottles and vials.

Sizes available include:

3 5 7 10 15 20 25 30 50 100



Rubber Stoppers for Parenteral and Diagnostic Bottles and Vials

A comprehensive range of rubber stoppers in various sizes including 13mm, 14mm, 18mm, 20mm and 32mm.

- Materials include bromobutyl and chlorobutyl.
- Freeze dry stoppers an integral part of the range.
- Inert ETFE coated stoppers means reduced sorption of product onto rubber surface.
- **Premium coated stoppers now available for sensitive formulations.**



Glass Ampoules in Tubular Glass Type 1



A range of Neutral Type 1 Glass Ampoules in amber and clear glass

Manufactured to ISO 9187 specifications.

Forms include:

Form B (Straight Stem Open Ampoules)

Form C (Open Funnel Ampoules)

Form D (Closed Ampoules)

Sizes available include:

1 2 5 10 20 25

All capacities in ml.

Dispensing Solutions for healthcare and pharma products

We offer an extensive portfolio of dispensing solutions specifically developed for the healthcare industry.



A range of high quality spray pumps and lotion dispensing systems with a high degree of accuracy and consistency of application.

Manufactured in a clean environment, certified as an ISO Class 7 Zone with full DMF (Drug Master File) certification. Snap-on, crimp-on and screw-on closure systems with a wide range of closure specifications.

PRESERVATIVE-FREE PUMP SYSTEMS.

Applications include: NASAL, OPHTHALMIC, BUCCAL, AURICULAR and TOPICAL.

FULLY COMPATIBLE with our **EXTENSIVE RANGE** of **PLASTIC VIALS** and **GLASS VIALS** in type 1, type 2 and type 3 glass.



A range of dosing and dropper caps with the added benefits of child-resistance and tamper-evidence.

An extensive range of CE marked measuring cups, designed to fit our standard child-resistant and tamper-evident closure ranges.



Dispensing Solutions for healthcare and pharma products



Tamper-Evident Lotion Dispensers

Tamper-evident Lotion Dispensers are designed to enhance product safety and integrity. The tamper-evident band on the closure of the dispenser provides a deterrent to opening or interfering with the contents of the bottle.

Metal-free fluid path enhances protection for sensitive product formulations.

Plastic Oral Dosing Syringes

A comprehensive range of CE marked graduated plastic oral dosing syringes in a variety of sizes including 0.5ml, 1ml, 3ml, 5ml, 10ml and 20ml. Press-in-bottle adaptors available for both glass and plastic bottles to enhance convenience. Individual protective sachet option available to enhance cleanliness.



Powder Scoops

A wide range of standard plastic powder scoops in sizes ranging from 5ml to 60ml.



Finger Sprayers with Overcap

All plastic options
now available



Overcap options include
translucent and
solid colours



Available in a range of sizes including 18mm, 20mm, 22mm, 24mm and 28mm.

Colours available include white, natural and black, with special colours available on request.

Closures available include smooth or ribbed.

Special colours
available on request



Finger Sprayers with Overcap and Anodised Aluminium Closure



Brand embossing
service available for
aluminium overshell

Available in 24mm size.

Colours include white, natural and black actuator with shiny silver overshell.

Overshell also available in matt silver, matt gold and shiny gold.

Finger Sprayer with Anodised Aluminium Closure and Natural Safety Clip

Available in 18mm, 20mm and 24mm closure options.



Mini Trigger Sprayers
Available direct from stock

All plastic options
now available



NEW



Available in 20mm, 24mm and 28mm sizes.
Colours available direct from stock include white, natural and black, with special colours available on request.
New High Viscosity Version now available for dispensing viscous liquids.

24mm 410 and 28mm 410 360° SPRAYER

Spray from any angle to get into those awkward corners

Lock Up and Lock Down Lotion and Gel Dispensers
Available direct from stock

Lock Up Dispensers eliminate discharge of product during locking
Lock Down Dispensers provide a more compact pump



Available in 22mm, 24mm and 28mm sizes.
Colours available direct from stock include white, natural and black, with special colours available on request.
Available in a range of different outputs.
Closures include ribbed and smooth options with a wide range of different actuator styles such as Palm Top.

Lock Up Lotion and Gel Dispensers with Anodised Aluminium Closure
Available direct from stock



Brand embossing
service available for
aluminium overshell

Available in 24mm and 28mm sizes.
Colours available direct from stock include white, natural and black with shiny silver overshell.
Special colours available on request including matt silver, matt gold and shiny gold overshells.

Treatment Pumps

Available direct from stock

A wide range of different treatment pumps available from stock.

Primarily used for dispensing smaller volumes of cosmetic creams, gels and lotions in outputs between 0.2ml and 1.0ml.

Available in 18mm, 20mm, 22mm and 24mm.

Colours available include white, natural and black with gold and silver matt and shiny oversHELLS.

CUSTOM COLOURS available on request.



Tamper-Evident Lotion Dispensers

Tamper-Evident Lotion Dispensers are designed to enhance product safety and integrity. The tamper-evident band on the closure of the dispenser provides a deterrent to opening or interfering with the contents of the bottle.

Metal-free fluid path enhances protection for sensitive product formulations.

Well Pumps

An innovative dispensing pump. Ideal for use with makeup remover, nail varnish remover, toners and cleansers where a pad application is required. Press down on the pump to dispense product into the concave application well and apply product from the well.

Available with a range of bottles in PET, HDPE and Polypropylene

Available in a range of sizes including 24mm, 28mm and 33mm.

CUSTOM COLOURS available on request.



Trigger Spray Dispensers, Tamper-Evident Lotion Dispensers, Powder Scoops and Pourer Sprinkler Caps

Trigger Spray Dispensers

An extensive range of trigger sprayers are available from stock in multiple colours. Twenty five different shroud styles available on request.



Tamper-Evident Lotion Dispensers

Tamper-Evident Lotion Dispensers are designed to enhance product safety and integrity. The tamper-evident band on the closure of the dispenser provides a deterrent to opening or interfering with the contents of the bottle.



Metal-free fluid path enhances protection for sensitive product formulations.

Powder Scoops

A wide range of standard plastic powder scoops in sizes ranging from 5ml to 60ml.



Pourer Sprinkler Caps

A range of Pourer Sprinkler Caps available in 38mm, 48mm, 53mm, 63mm, 70mm, 89mm and 110mm sizes. Available with or without liner.



All capacities in ml.



Disc Top Caps

Available in a range of sizes including: 18mm, 20mm, 24mm and 28mm.



Swirly Disc Top Caps



FlipTop Caps Available direct from stock

Available in a range of sizes including 20mm, 24mm, 28mm and 38mm. Colours available direct from stock include white, natural and black. Special colours available on request.

Twist Open/Close Caps

Available in a range of sizes including 20mm, 24mm, 28mm and 38mm with boreseal or fitted liner insert. Colours available include white, natural and black. **CUSTOM COLOURS** available on request.



Push Pull Caps

Available in a range of sizes including 24mm and 28mm.



Flip Open/Close Caps

Available in 24mm and 28mm sizes.

All capacities in ml.

Aluminium Bottles and Jars



Aluminium Bottles

A wide range of aluminium bottles from 30ml to 1000ml. Standard 24mm 410 neck finish across the range. Brushed aluminium colour available along with other colours on request. High quality thermal printing available for up to ten colours.

Aluminium bottles available direct from stock include:

30 50 100 150 200 250 300 500 1000



Coloured and Printed Aluminium Bottles

Coloured and printed aluminium bottles available for minimum order of 5,000 units.



Aluminium Jars

An extensive family of wide neck aluminium jars with matching screw on aluminium closures.

Aluminium jars sizes:

Aluminium: 10 15 30 50 75 100 150 200 250

Flexible packaging

Neville & More is your reliable partner for top-notch flexible packaging solutions and unparalleled customer support. Flexible packaging is a fantastic choice for a variety of products like coffee, specialty food, pet products, etc. Innovation and package engineering have led to the development and use of lighter weight flexible packaging materials that enhances the final product's shelf appeal, barrier strength, protection, and the ability to be sealed. Whether your requirements are stock or custom, short or long term, simple or complex, we are committed to tailoring solutions that align with your business goals:



Ready-to-Ship Stock Bags:

Explore our range of ready-to-ship stock bags, available for quick online ordering and shipped from local warehouses within two business days.

Custom Printing Services:

Elevate your brand with our in-house design services, offering a variety of custom printing options, from short-run digital printing to full-speed production.



Commitment to Sustainability:

Our commitment to quality, sustainability, and reliability is evident in our innovative products, including compostable coffee bags and recycle-ready packaging.

Popular Packaging Formats:

- Side Gusseted Bags
- Stand-Up Pouches
- Block Bottom Bags
- Flat Pouches
- Paper Tin-Tie Bags
- One-Way Degassing Valves



Partner with Neville & More for a flexible packaging solution that exceeds expectations. Our experienced team provides personalized service at every step of your packaging journey.

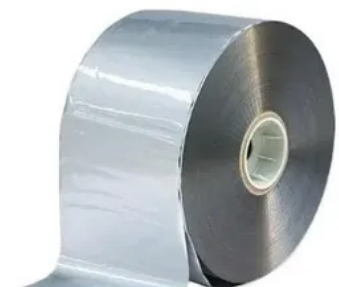

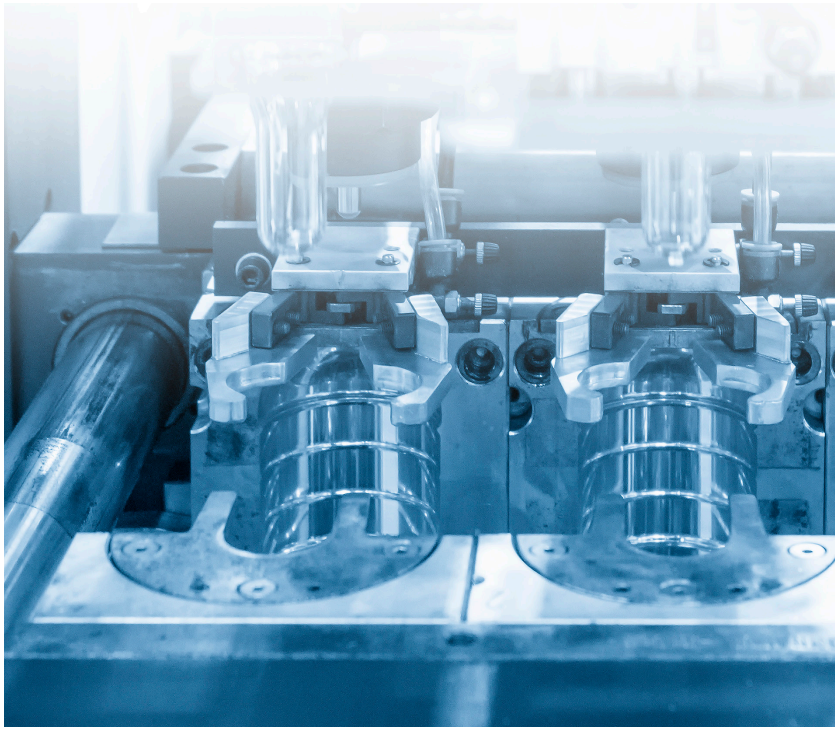

Design & Engineering from Concept to Shelf

At Neville and More, we provide you with a one-stop-shop for custom package design. We take pride in delivering commercial-ready custom packaging that will delight consumers and drive brand loyalty. Our insight-driven Design & Engineering process means your packaging will be functional for the consumer and keep them coming back. We focus on quality, detail, and successful commercialisation at every step of the custom design process. Because when you win, we win too.

At a Glance



INSIGHT-DRIVEN custom packaging



WORLD-CLASS industrial and graphic design support including engineering and technical expertise



TECHNICAL EXPERTS across packaging multiple formats and materials



MORE THAN 300 design and utility **PATENTS**



OVER 100 acclaimed industry **AWARDS**

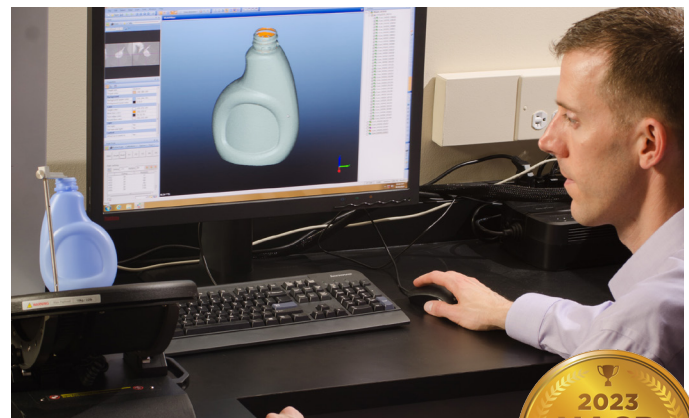

2023 NACD
Packaging Award Wins



9
WINS





Neville and More Environmental Policy

Neville and More operates from a recently constructed facility that incorporates the latest energy conservation technologies.

This includes roof mounted solar panels that create an energy neutral building.

This efficiency is reinforced by the use of the latest building materials such as cladded wall panels to increase the insulation and reduce energy loss from our facility.

We have installed a baler system at our facility in order to compact and recycle paper, board and plastic materials.

Any rejected glass is also recycled.

Whilst appreciating that packaging is an indispensable part of modern life, Neville and More is sensitive to the impact that packaging waste materials can have on our environment.

The raw materials used in the manufacture of Neville and More products are all recyclable.

This includes glass bottles, glass jars, HDPE bottles, polypropylene jars, PET bottles, PET jars and polypropylene closures.

Due to the growing concern about the environmental impact of PVC, Neville and More phased out the usage of all PVC containers many years ago.

Neville and More is actively supplying products manufactured from post-consumer recycled resins. This includes PET bottles and jars and polypropylene closures that are used in the Healthcare and Pharma Industries.

Exhibition Centre

Visit our brand new Packaging Exhibition, Innovation and Sampling Centre. A unique display of innovative bottles, jars, closures, dispensers and sprayers from the very best manufacturing facilities throughout the world.



Gain inspiration with innovative, quality packaging solutions, tailored to your needs, giving you the competitive advantage essential in today's marketplace.

Accelerate and simplify your product development process by discussing the benefits of different packaging options with our highly experienced team of packaging experts.

Enjoy this unique opportunity to see, under one roof, our complete, extensive and ever growing product range.



Having identified the most appropriate packaging for your product, go straight to our adjacent, integrated sampling centre to select the samples of your choice ready to take away there and then.



“Reduces decision times by being able to compare packaging instantaneously rather than the procrastinated alternative of postal samples.”

Sampling Centre

Our extensive Product Sampling Centre contains thousands of different bottle, jar, closure, dispenser and sprayer samples, all meticulously labelled and archived for rapid identification, collection or despatch.

Efficient selection and shipment of samples to our clients is an essential part of our customer service and a requirement to enable our customers to carry out relevant and timely consumer product research and essential compatibility testing.

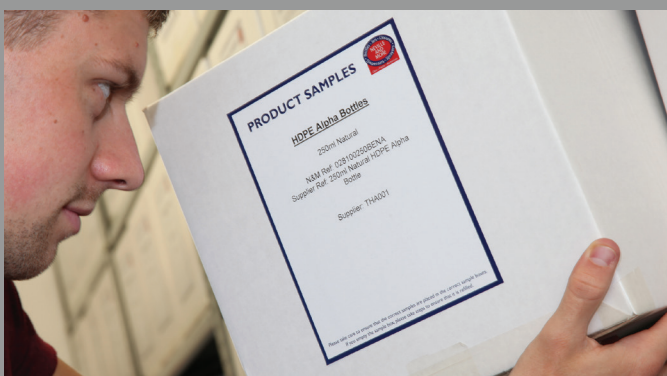

Neville and More distribution centre, exhibition and sampling centre and testing laboratory



Our facility includes a purpose built distribution centre, assembly and dispenser dip tube cutting suite, product exhibition/sampling centre and testing laboratory.

Our distribution hub provides capacity for several thousand fully racked pallet spaces which enables safe, clean storage, traceability, safety stock and just-in-time delivery.

This incorporates state-of-the-art photovoltaic solar panels to generate its own efficient source of renewable energy which satisfies all operating power requirements within the building.

Our storage facility is split into two separate units, interconnected by a fire proof tunnel.

This facilitates continuity of supply and built in contingency arrangements in the event of an unexpected incident in one of the facilities. It also satisfies a key disaster recovery requirement not only for Neville and More but for all the industries we supply to.



Exhibition and Sampling Centre

Visit our unique display of innovative bottles, jars, closures, dispensers and sprayers.

Testing Laboratory

Our in-house laboratory can carry out tests such as accelerated shelf life compatibility and vacuum leak testing.



NEVILLE & MORE

A TRICORBRAUN COMPANY®

Neville and More, Unit 15, Oakhurst Business Park, Southwater, West Sussex RH13 9RT, England

Tel: +44(0)1403 732290

www.nevilleandmore.com